

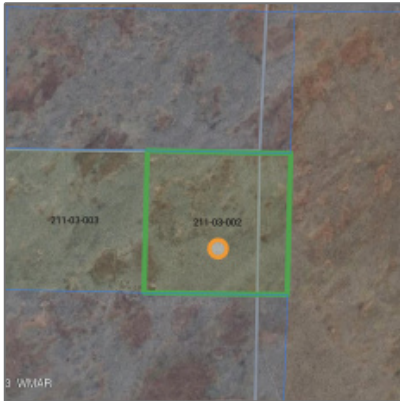

## TBD East of petrified forest, St. Johns, Arizona 85936

- TBD East of petrified forest, St. Johns, Arizona 85936



### Facts and features

Price/acre: **\$475**

Days On Market: **123**

### Facts and features

Price: **\$19,000**

Property Type: **Land**

Listing ID: **247916**

Lot Area: **40 Acre**

### Property details

Timestamp: **01.09.2024  
13:02:04**

Status: **Active**

Area: **St. Johns**

Lot Dimensions: **284.91 X 120 X  
259.31 X 249.8**

### Neighborhood / Community

Neighborhood / Subdivision: **Big Valley Ranches**

Country: **US**

State: **AZ**

City: **St. Johns**

Zipcode: **85936**

Zoning:	<b>Gu County</b>
Taxes:	<b>2906.84</b>
Tax Year:	<b>2019</b>
Waterfront:	<b>No</b>
Short Sale:	<b>No</b>
HOA:	<b>No</b>
HOA Frequency:	<b>Quarter</b>
Exterior Features: N/A - Other:	<b>Juniper/pinon, meadow</b>
Trees on property:	<b>Yes</b>
Power available:	<b>No</b>
Water available:	<b>No</b>

#### Other

Horses:	<b>Yes</b>
Maintained road:	<b>No</b>

#### Listing [provided by](#)

Office name:	<b>Landmark Homes LLC</b>
Listing agent name:	<b>Benjamin Brown</b>

#### Agent [Info](#)

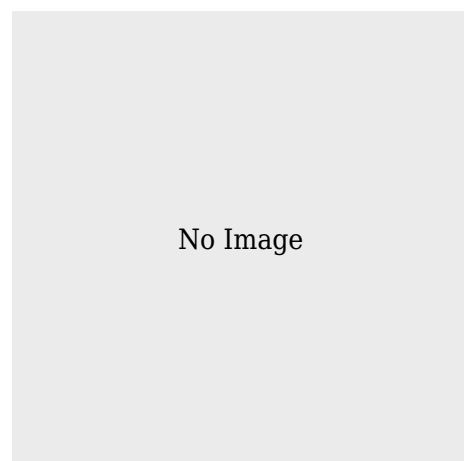

Teri Meacham  
 [livingontherim@gmail.com](mailto:livingontherim@gmail.com)

928.240.0783 - 1824 AZ-260 Suite A, Heber, AZ 85928

**Teri Meacham | West USA Realty**